

The Tiffany™ T80 Series

T80-S | T80-T

Full-Height Turnstile | Interior & Exterior Application

The Tiffany™ T80-S Series (single, shown at right) and the T80-T (tandem, shown below) are high security, tamper-resistant, full-height turnstiles. Both variations are manufactured with 6061/T6 anodized aluminum ovaline arms and feature scratch-resistant polycarbonate yoke assemblies for an open appearance. The T80 series is driven by our reliable 6500 Series Control Head to accommodate your security requirements.



T80-T with
T36-ADA door



We're the #1 Choice of Top Architects, Security Pros and Engineers

For more than 30 years, Controlled Access has been the globally trusted name in pedestrian control equipment. Made in Ohio and shipped worldwide, we are the first choice of leading architects, facility managers, security consultants, and engineers. Whether your project requires high security full-height turnstiles, waist high units, or matching ADA accessible gates, Controlled Access is the secure choice. We're experienced in access control systems, from card readers to biometric scanning, to give you the power to control access.



The T-80 series is also
available with integrated
metal detection portal

CA **Controlled Access, Inc.**
Turnstiles and ADA Gates

1535 Industrial Parkway South, Brunswick, OH 44212

PH: 330.273.6185 | Fax: 330.273.4468
Toll-Free Ph: 800.942.0829 | Toll-Free Fax: 800.942.0828

E-mail: sales@controlledaccess.com
www.controlledaccess.com

The Tiffany™ T80 Series

Full-Height Turnstile | Interior & Exterior Application

T80-S | T80-T

Applications:

The Tiffany™ T80 Series is a three-vane turnstile with a weather resistant finish and is ideal for interior or exterior placement - whenever style and durability are needed. It is crafted from 6061 and 6063 aluminum extrusions and features transparent scratch-resistant polycarbonate yoke assemblies.

Product Features:

Materials & Finishes:

- Various 6061 & 6063 extruded aluminum
- 3/16" scratch-resistant polycarbonate
- Finish: Standard anodizing finish is clear. Also available in dark bronze. Other colors can be quoted upon request.

Assembly & Hardware:

- Major components pre-assembled with concealed rods and spring pins
- Barrier and yokes secured with 3/4" rod epoxied into concrete
- Rotor pivots on a sealed load runner bearing, secured with high strength plastic coupling anchored into concrete
- Minimum of 4" needed for removal of cover

Dimensions:

T80-S (Single)

- **Ovaline Arms:** 1/2" x 2" x 24"
- **Exterior Height:** 91" (2311.4mm)
- **Interior Height:** 84" (2133.6mm)
- **Width:** 66.250" (1682.7mm)
- **Pedestrian Clearance:** 27.750" (704.8mm)

T80-T (Tandem)

- **Ovaline Arms:** 1/2" x 2" x 24"
- **Exterior Height:** 91" (2311.4mm)
- **Interior Height:** 84" (2133.6mm)
- **Width:** 96.250" (2444.7mm)
- **Pedestrian Clearance:** 27.750" (704.8mm)

* Dimensions are subject to change without notice

Operation Features

6500 Series Control Head:

- Auto-indexing (self-centering) with adjustable hydraulic shock suppression
- Hardened tool steel locking bars, cam and roller assemblies
- Permanently lubricated bearings
- Your choice of manual or electronic control on both directions
- Nearly universal integration to any number of access control systems
- Your choice on each electronic direction of locking or unlocking on power failure

Options:

- Card reader mounting plates
- Daylight visible indicator lights
- Bi-directional key overrides
- 8 digit key resettable LCD counter with seven year lithium battery
- Metal detection portal
- Cold weather package, including thermostat controlled heater and insulated mainframe
- Additional options available upon request

Warranty:

Units are warranted against defects in materials and workmanship for a period of one year from date of delivery. See warranty information for specific details.

Electrical Specifications:

Input Voltage: 100-240 VAC
Input Current: 1.3 - .55 A
Frequency: 50/60 Hz

Storage Temperature: -40 to 158°F
Operating Temperature: -4 to 131°F

Operating Voltage: 24VDC
Operating Current: 1.2 A (typical)



The 6500 Series Control Head is certified to conform to the following standards:
UL 294, UL 325, UL Subject 2593,
CAN/ULC S319 & CSA C22.2#247



Controlled Access, Inc. is certified by Advantage International Registrar to be an ISO 9001:2015 company

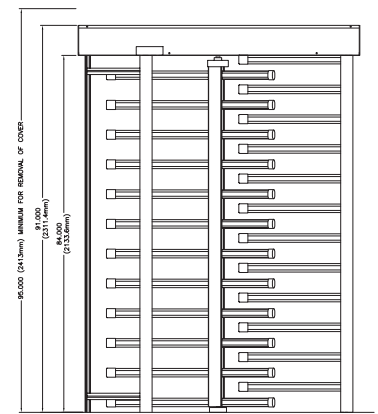
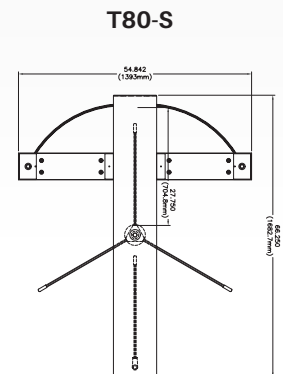
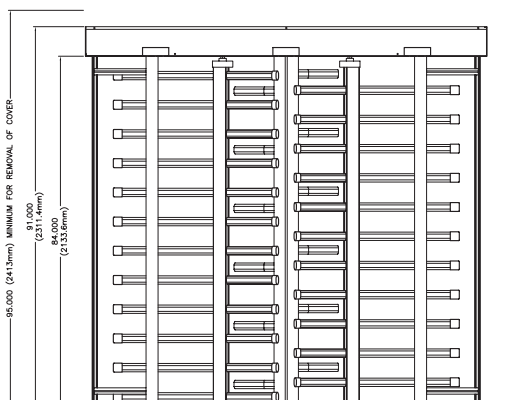
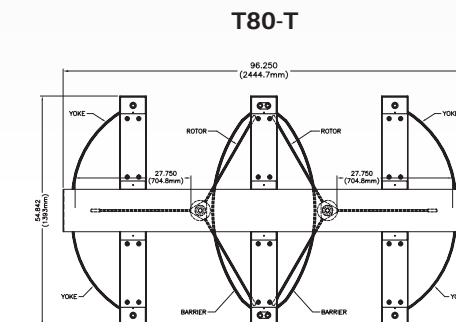

* Dimensions are approximate

Controlled Access, Inc.
Turnstiles and ADA Gates

1535 Industrial Parkway South, Brunswick, OH 44212

PH: 330.273.6185 | Fax: 330.273.4468
Toll-Free Ph: 800.942.0829 | Toll-Free Fax: 800.942.0828
E-mail: sales@controlledaccess.com
www.controlledaccess.com