



Leaders in Access Control for Over 45 Years

P.O. Box 815, Brunswick OH 44212-0815

Phone: 330-225-3029 Fax: 330-225-3009

Toll-Free: 1-888-225-3029

*INSTALLATION
AND
SERVICE MANUAL
FOR
CLASSIC SERIES
HG-81
WAIST HIGH
HANDICAPPED GATE*

IMPORTANT: Please save this booklet after installation. If installation is done by Construction Company, please give this booklet to customer when installation is complete. They will require it for maintenance and repairs.

Thank you.

P.N. HG81

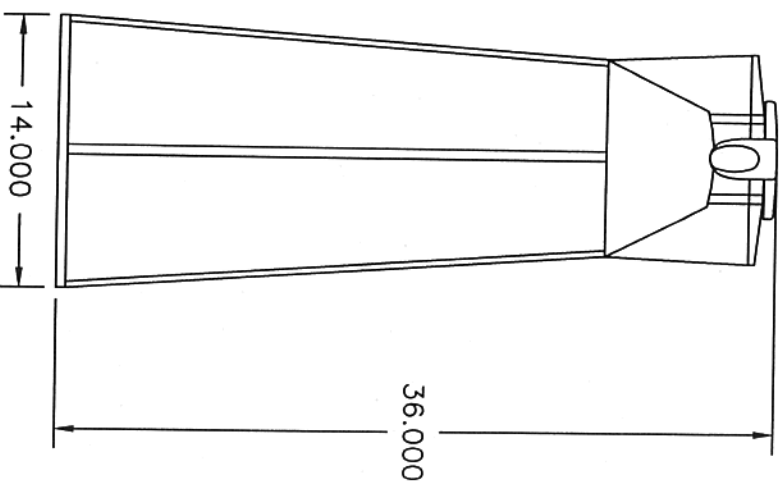
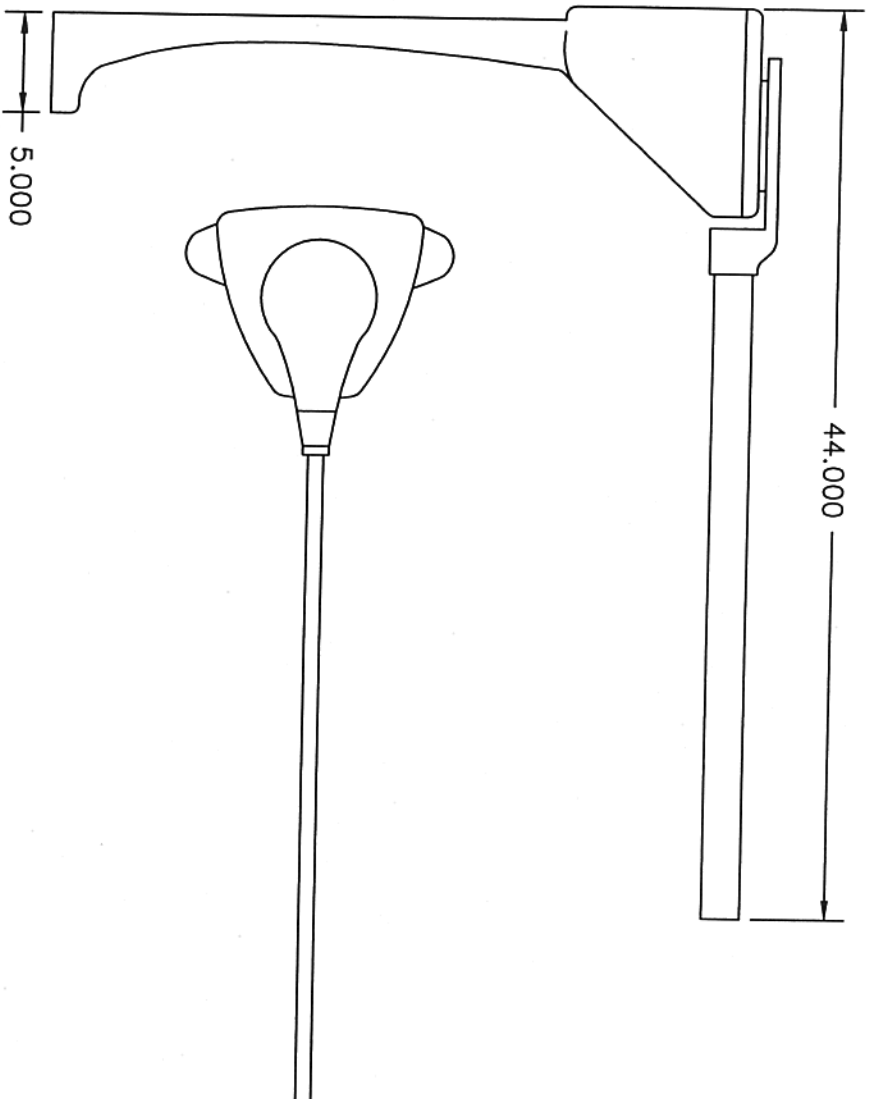

MATERIAL:

SCALE: 10=1

APPROVED BY:

DRAWN BY: LC IIII

DATE: 8/19/03

REVISED:

FINISH:

TOL. UNLESS OTHERWISE SPEC.

.X \pm .1 .XXX \pm .015
.XX \pm .03 ANGLES .5°

Sentronic
International

330-225-3029
FAX 330-225-3009
USA 1-888-225-3029

P.O. Box 815
Brunswick OH 44212

CLASSIC SERIES ADA GATE

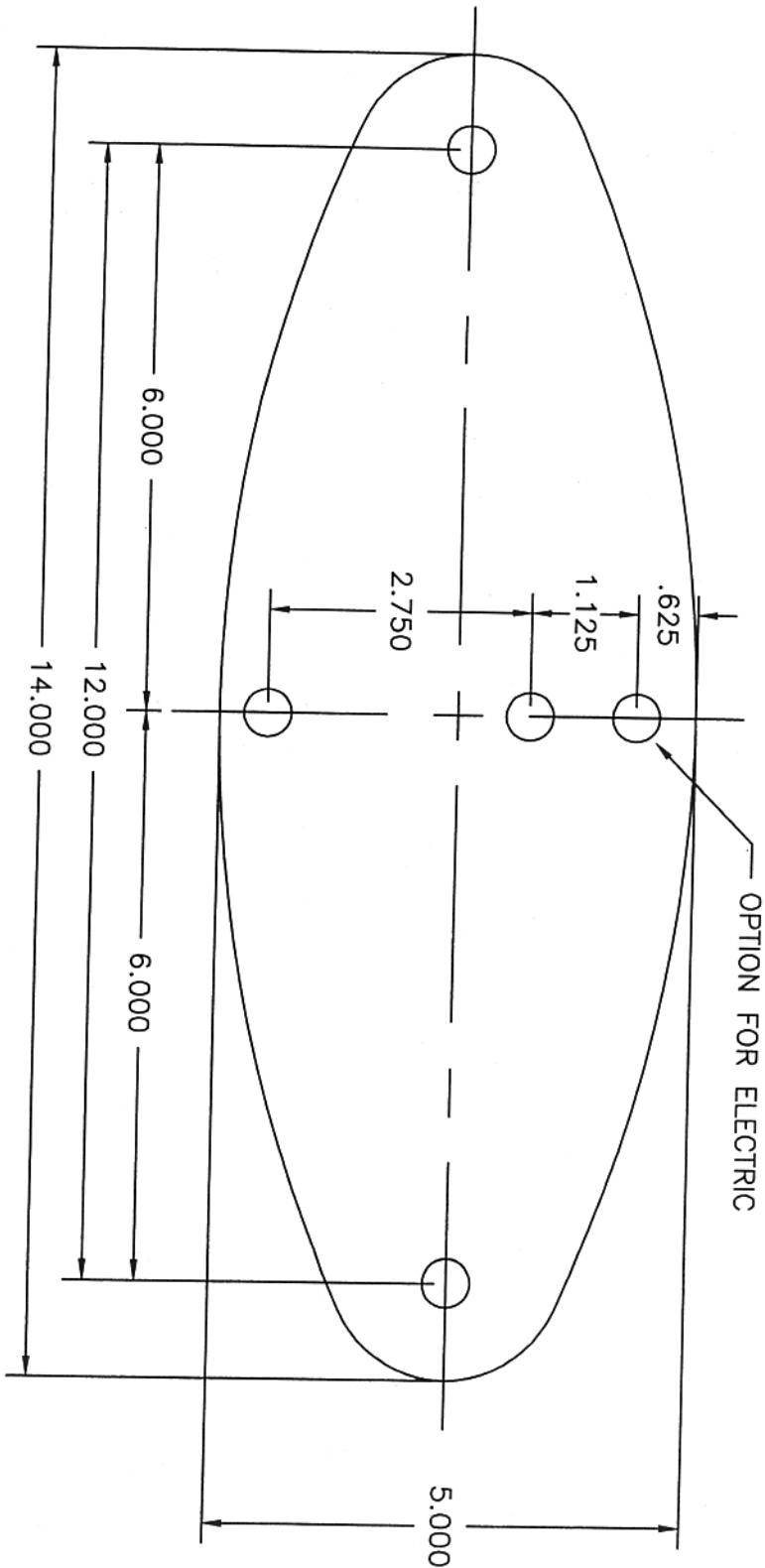

NOTE: ALL HOLES ARE ϕ .500

ARM

MATERIAL:		SCALE: 10=1		APPROVED BY:	
FINISH:		DATE: 8/19/03		DRAWN BY: LC III	
TOL. UNLESS OTHERWISE SPEC.		Sentronic International P.O. Box 815 Brunswick OH 44212 330-225-3029 FAX 330-225-3009 USA 1-888-225-3029			
.X \pm .1		CLASSIC SERIES FOOTPRINT CS79/HG81			
.XX \pm .03		ANGLES .5° REVISED:			

Concrete Wedge Anchor Installation Instructions

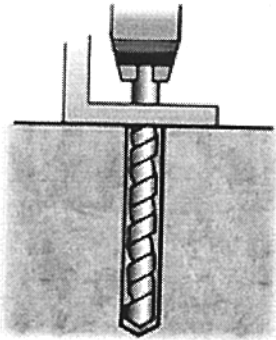

1. Drill hole 1/2" to 1" deeper than anchor embedment. Clean hole of debris.

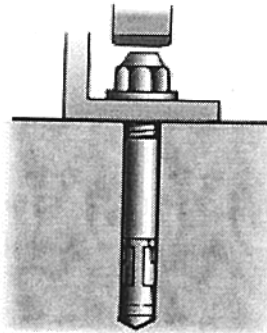

2. With nut threaded past the end of stud, hammer into position.

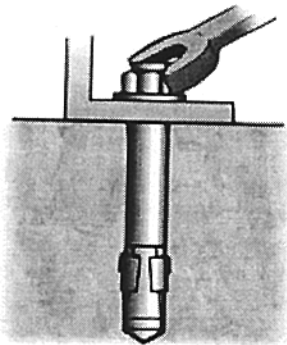

3. Tighten finger tight plus an additional 3-5 turns with wrench.

Instructions for Using Wedge Anchors

Determine the appropriate wedge anchor length for your project.

1. Add:
The thickness of material to be fastened
-to-
The minimum embedment required
-to-
The thickness of the nut and washer (about one anchor diameter).
2. Once you have determined the appropriate wedge-type-anchor length, drill your hole using a bit with the same diameter, $\frac{1}{2}$ " deeper than the anticipated anchor embedment.
3. Clean the drilled hole of any debris.
4. Thread the nut and washer until the nut is flush with the top of the anchor.
5. Hammer it into position (nut and washer flush with the surface of the material).
6. Tighten finger completely and then take an additional 3-5 turns with the wrench.
7. If the anchor spins in the hole, force it up using a screwdriver until the clip binds into the concrete.

Thunderstud® Wedge Anchor Technical Information

Diam. & Length	Min. Embedment	Thread Length
1/4"	1-1/8"	3/4"
3/8"	1-1/2"	7/8"
3/8"	1-1/2"	1-1/8"
1/2"	2-1/4"	1-1/4"
1/2"	2-1/4"	1-1/4"
5/8"	2-3/4"	2"
5/8"	2-3/4"	2"
5/8"	2-3/4"	2"
3/4"	3-1/4"	2"
3/4"	3-1/4"	2"
3/4"	3-1/4"	2"
7/8"	3-7/8"	2-1/4"
1"	4-1/2"	2-1/4"
1-1/4"	5-1/2"	3-1/4"

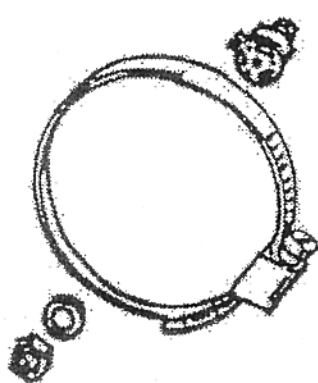
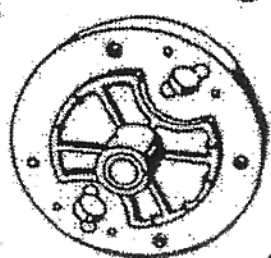
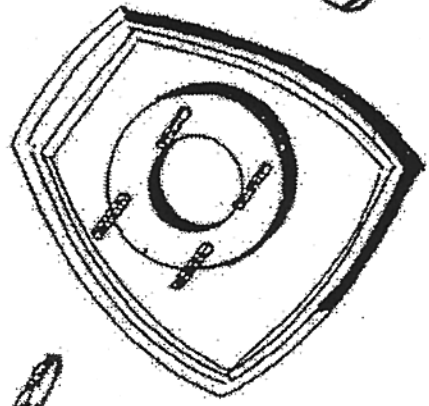
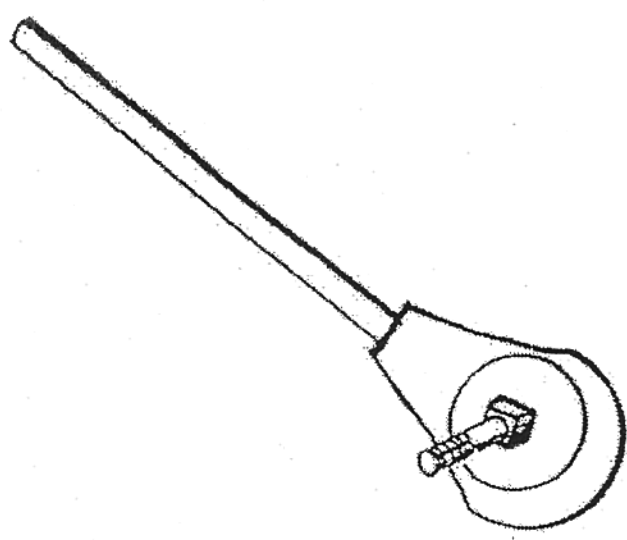
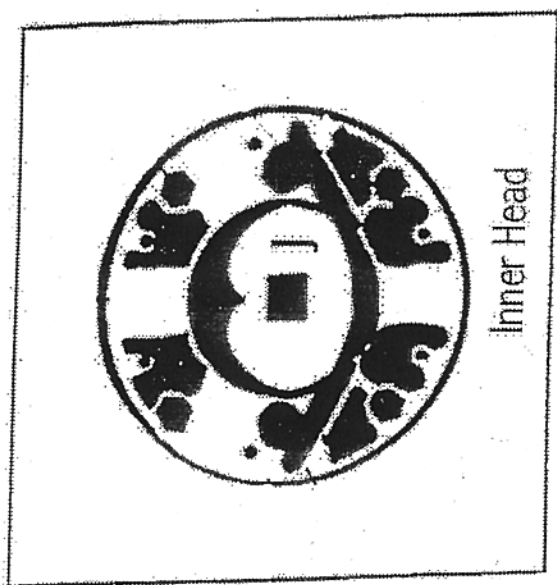

CLASSIC HG-81 CONTROL HEAD



PO Box 815 Brunswick, OH 44212-0815

Tel: 330-225-3029 or 888-225-3029

Fax: 330-225-3009

Web: sentronicinternational.com

Email: sales@sentronicinternational.com

June 2007

Leaders In Access Control For Half A Century

CLASSIC SERIES HG-81 PARTS LIST

PART NO.	PART NAME	COST
0708	Inner Head	\$268.00
0711	Rotary solenoid & pinion gear – CW	\$198.00
0712	Rotary solenoid & pinion gear – CCW	\$198.00
0780	24VDC 3amp Power Supply	\$42.11
0789	PC Control Board	\$162.72
1700	Limit Switch	\$52.79
1702	Outer head/arm assembly	\$321.00
1706	CF Compression Spring	\$2.14
1707	Cam Follower	\$33.70
1710	Cam	\$93.63
1712	Cover Cap	\$81.21
1716	Bottom Cover Plate	\$32.90
1719	.625 nut/washer	\$1.19
1720	Clamp	\$3.95
1721	CF Spring Centerer	\$2.14
1723	Geared Pawl	\$67.41
1724	Plain Pawl	\$28.89
	Manual Control Head	\$840.00
	Control Head / Elect. 1 way	\$1,455.00
	Control Head / Elect. 2 way	\$1,690.00

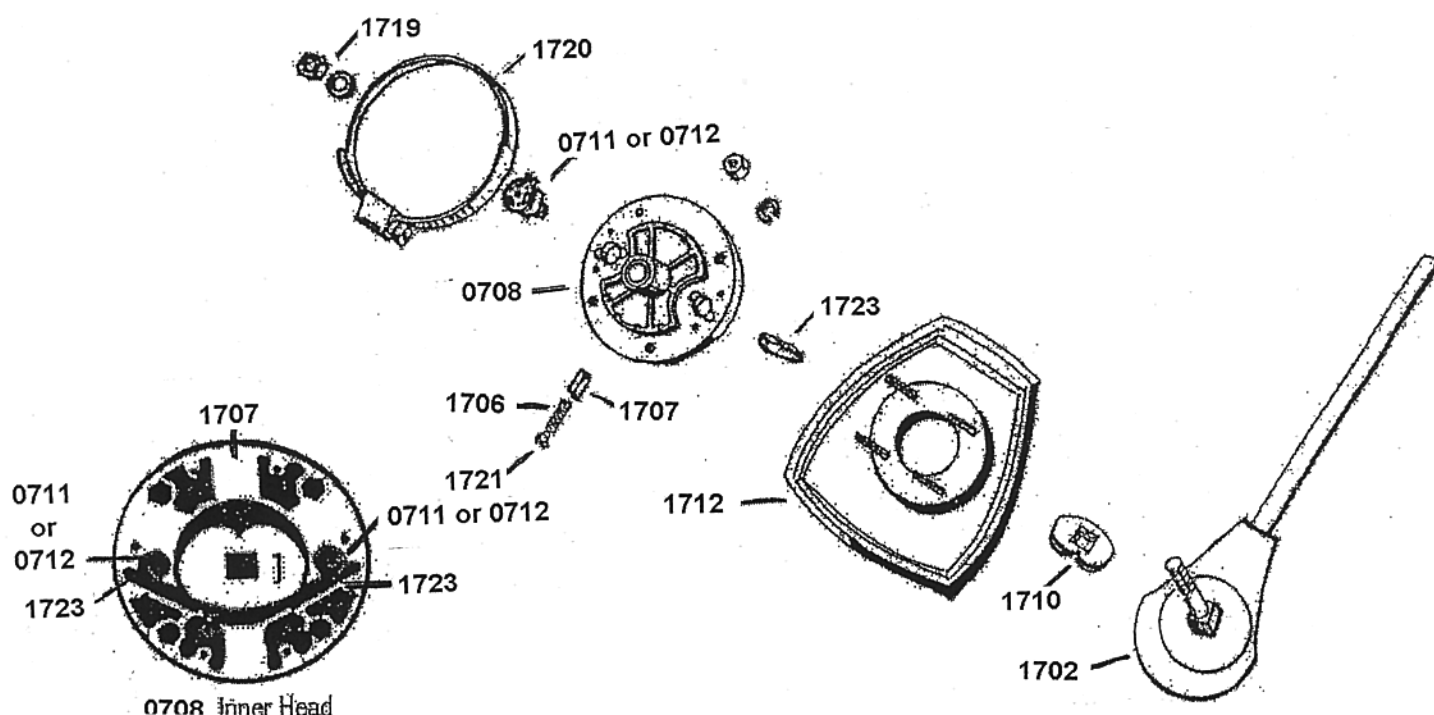



Leaders in Access Control for Over 45 Years

P.O. Box 815, Brunswick OH 44212-0815
Phone: 330-225-3029 Fax: 330-225-3009
Toll-Free: 1-888-225-3029

***CLEANING & CARE INSTRUCTIONS
FOR
CLASSIC HG 81 HANDICAPPED GATE***

1. Remove four mounting 10-24 pan head screws to release control head from housing.
2. Place control head upside down on a workbench or floor with M708hg inner head facing up.
3. Remove nut/lock washer of shaft M703 and clamp M 704; then remove the one N705hg spring centerer M706hg CF compression spring and cam follower M707.
4. Remove inner head M708hg from shaft along with bearing on top and the bottom of the inner head. Remove inner cover to inner head and carefully note location of geared pawl M709, but do not remove cam M710hg unless it is damaged and must be replaced. If cam is to be replaced, note its exact location on shaft.
5. Rotary solenoid and pinion gear M711 is of the continuous duty type. Make sure pawl is advanced as far forward in inner head as possible when resetting solenoid, pinion gear and geared pawl; otherwise the cam will slip past the pawl and not lock properly.
6. Reverse procedure to reassemble after cleaning and applying silicone or teflon lubricant to all moving parts.

SENTRONIC[®]
INTERNATIONAL

SENTRONIC
INTERNATIONAL
P. O. BOX 815
BRUNSWICK, OHIO 44212
(330) 225-3029 PHONE
(888) 225-3029 TOLL-FREE
(330) 225-3009 FAX

ENT. TIMER

EXT. TIMER

ALARM TIMER

ENT. INPUT+

ENT. INPUT-

LIM. SWITCH 1+

LIM. SWITCH 1-

EXT. INPUT+

EXT. INPUT-

LIM. SWITCH 2+

LIM. SWITCH 2-

ALARM INPUT+

ALARM INPUT-

INPUT 24V+

INPUT 24V-

ENT. SOL NO

ENT. SOL NC

ENT. SOL COM

ENT. LIGHT NO

ENT. LIGHT NC

ENT. LIGHT COM

EXT. SOL NO

EXT. SOL NC

EXT. SOL COM

EXT. LIGHT NO

EXT. LIGHT NC

EXT. LIGHT COM

ALARM OUTPUT NO

ALARM OUTPUT NC

ALARM OUTPUT COM

ANTI BACKUP NO

ANTI BACKUP NC

ANTI BACKUP COM

SEN-789





WIRING LEGEND FOR SEN-789 TURNSTILE CONTROL BOARD

NOTE!! THIS IS A MULTIPURPOSE CONTROL BOARD - NOT ALL FUNCTIONS ARE USED

All outputs on right side of board are 24 vdc+, use 24 vdc- terminal bottom left side for other leg when wiring solenoids and lights.

Timer controls length of time for person to enter	ENT TIMER	ENT SOL NO	Enter fail lock Solenoid 24 vdc+
Timer controls length of time for person to exit	EXT TIMER	ENT SOL NC	Enter fail open Solenoid 24 vdc+
Timer controls length of alarm to sound	ALARM TIMER	ENT SOL COM	Not Used
Contact closer of these two terminals by push button or card reader unlocks turnstile entrance	ENT INPUT + ENT INPUT -	ENT LIGHT NO	Status light 24 vdc+
Contact closer of these two terminals by limit switch on control head relocks after one person enters	LIM SWITCH 1+ LIM SWITCH 1-	ENT LIGHT NC	Status light 24 vdc+
Contact closer of these two terminals by push button or card reader unlocks turnstile exit	EXT INPUT + EXT INPUT -	ENT LIGHT COM	Not Used
Contact closer of these two terminals by limit switch on control head relocks after one person exits	LIM SWITCH 2+ LIM SWITCH 2-	EXT SOL NO	Exit fail lock Solenoid 24 vdc+
		EXT SOL NC	Exit fail open Solenoid 24 vdc+
		EXT SOL COM	Not Used
		EXT LIGHT NO	Status light 24 vdc+
		EXT LIGHT NC	Status light 24 vdc+
		EXT LIGHT COM	Not Used
		ALARM OUTPUT NO	Cover alarm 24 vdc+
		ALARM OUTPUT NC	Not Used
		ALARM OUTPUT COM	Not Used
		ANTI SOL NO	Anti-backup solenoid Fail open 24 vdc+
		ANTI SOL NC	Anti-backup solenoid Fail lock 24 vdc+
		ANTI SOL COM	Not Used

NOTE- If only one limit switch exits install jumper wire to LIM SWITCH 1+ and LIM SWITCH 2+

Contact closer of these two terminals by cover tamper switch turns alarm on

ALARM INPUT +
ALARM INPUT -

18 to 30 vdc power supply input and one leg from all solenoids attached to vdc -

INPUT 24 V +
INPUT 24 V -

789 CIRCUIT BOARD TROUBLE SHOOTING

- 1) Isolate the card reader from the turnstile (card reader time should be less than 1 second anything more may allow two people to walk through the unit)
A one shot timer is available for purchase if the time cannot be achieved.
- 2) Using a jumper, make a **momentary** contact between either **ent+ and ent-** or **exit + and exit -** depending on which side you are trying to activate.
- 3) At this point the solenoid should release and the turnstile can be rotated.
If successful the turnstile will lock back up after rotation is completed. The card reader is the problem.
 - A) If not successful look to see if the triangle cam is actuating the limit switch. The limit switch will lock the unit back up.
Try actuating the limit switch by hand to see if it is working
 - B) Check for loose wires
 - C) Use meter to check for 24VDC
 - 1st check transformer
 - 2nd place one leg of meter on 24VDC negative on circuit board
place the other leg of meter on ENT SOL NC contact or EXT SOL NC contact. This checks for current going through the relay. If power is not there then the jumper on the circuit board may be missing or the relay may be bad.
 - D) Use meter to check Solenoid for 24VDC
If solenoid is wired into a normally open contact then initiate the turnstile
A normally closed contact should have power going to the solenoid.
If using transformer to check solenoid, solenoid must be disconnected from the Circuit board or back-feed will occur and could possibly short out the board.
- 4) If still unsuccessful the return the control head to the factory & our technicians will fully test the unit and make any repairs needed.



Leaders In Access Control For Half A Century

WARRANTY

Seller warrants the goods against defective workmanship and materials provided that Buyer notify Seller within one (1) year after receipt by Buyer of the goods of any claim under this Warranty. The liability of Seller shall be limited to replacing or repairing defective goods returned by Buyer and delivered to the factory of the Seller, transportation charges prepaid. Replaced or repaired goods will be redelivered freight prepaid to the address of Buyer shown hereon. Except for the Warranty contained herein, there shall be no other warranties, such as warranties of fitness and merchantability or otherwise; expressed or implied, written or verbal, and Seller shall not be liable for consequential damages in any event.