

HS336-ADA CARBON STEEL\STAINLESS STEEL MODELS  
 HS336-ADA-MS CARBON STEEL\STAINLESS STEEL MODELS

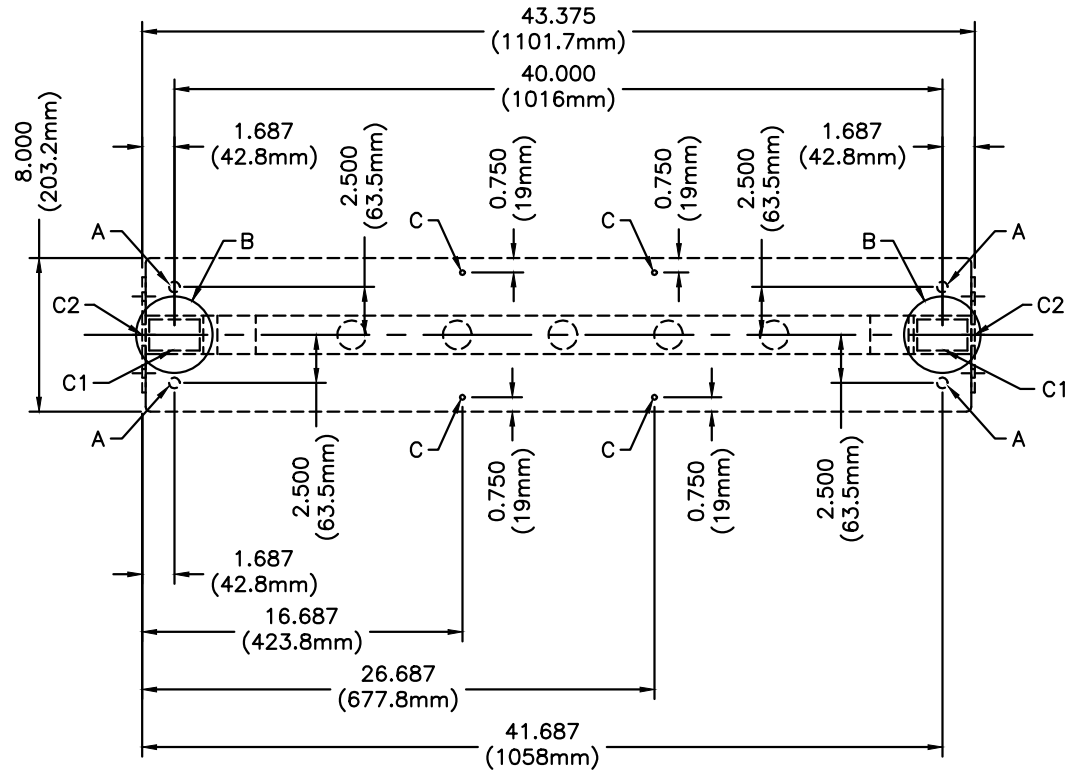
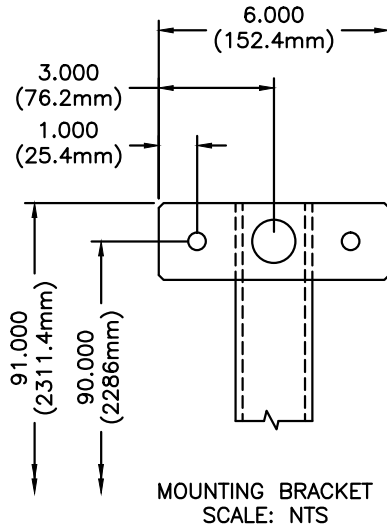

HS336-ADA NOTE:  
 GATE CAN BE EITHER RIGHT OR LEFT HANDED DIMENSIONS DO NOT CHANGE

ANCHOR POINTS  
 A= Ø0.500 x 4.500 STAINLESS STEEL CONCRETE ANCHOR QTY 4  
 B= Ø4.000 x 6.000 DEEP CORE DRILLED HOLE QTY 2  
 C= Ø0.250 FLAT HEAD TAPCON QTY 4

SUGGESTED CONDUIT LOCATION  
 C1= THROUGH GATE FRAME LEGS (2.000 x 3.000 x 0.187 WALL)  
 C2= THROUGH GATE MOUNTING BRACKET (TYP. BOTH SIDES)

CONCRETE PAD NOTE:  
 POUR PAD 4.000 [102mm] - 6.000 [152mm] THICK,  
 AND ENSURE IT IS LEVEL ±0.125 [3mm]

MATERIAL:	SCALE: 1=10	APPROVED BY:	DRAWN BY: LC III
CARBON STEEL\STAINLESS STEEL	DATE: 11/2018		REVISED:
FINISH:			
TOL. UNLESS OTHERWISE SPEC. .X ± .1 .XXX ± .015 .XX ± .03 ANGLES .5°		 CONTROLLED ACCESS, INC. 1636 West 130th Street Brunswick, Ohio 44212	330-273-6185 FAX 330-273-4468 USA 1-800-942-0829 FAX 1-800-942-0828
			HS336-ADA CONDUIT AND ANCHOR

PROPRIETARY AND CONFIDENTIAL  
 THIS DRAWING IS THE PROPERTY OF CONTROLLED ACCESS, INC. AND CONTAINS PROPRIETARY INFORMATION. IT MAY NOT BE COPIED, REPRODUCED OR TRANSMITTED IN ANY MANNER TO A THIRD PARTY WITHOUT PRIOR WRITTEN PERMISSION OF CONTROLLED ACCESS, INC.